

Care and Maintenance of Portable Meters

Idaho DHIA
Field Supervisor Meeting



Steven J. Sievert, Manager
Quality Certification Services Inc.

Topics to Cover...

- Maintenance of Approved Meters
- Calibration Requirements
- Storage and Transport of Meters
- Cleaning and Sanitizing Meters
- Proper Sampling and Reading



CARE AND MAINTENANCE OF PORTABLE METERS – SIEVERT 2010

2

Maintenance of Approved Meters

Tru-Test Pull-Out



- ▶ Most popular meter in Northeast and Midwest
- ▶ Easy to maintain
- ▶ Standard Bore (old) or Wide Bore (new) models
- ▶ Inefficient labor-wise
- ▶ Low cost of ownership



CARE AND MAINTENANCE OF PORTABLE METERS – SIEVERT 2010

4

Tru-Test Pull-Out - Maintenance



- ▶ Replace VSO at least once per year
- ▶ Replace gasket on cap yearly
- ▶ Do not over-tighten the flask foot
 - Places stress on meter body
 - \$200 repair cost
- ▶ New laser-etched flasks – do not use flask tapes on flasks for WB meters

Tru-Test Ezi-Test



- ▶ Most popular meter in the world
- ▶ Milk, Wash/Mix and Sample positions
- ▶ Standard Bore (old) or Wide Bore (new) models
- ▶ Self-contained (closed system)

Tru-Test Ezi-Test - Maintenance



- ▶ Annual Service Kit
 - Gaskets
 - Valve Assembly
- ▶ Broken baffle in valve
 - Will calibrate
 - Poor mixing and washing
- ▶ Plastic T-Piece
 - Easily broken
 - \$18.88 repair
- ▶ Store with valve in Milk Position

Tru-Test Ezi-Test - Maintenance

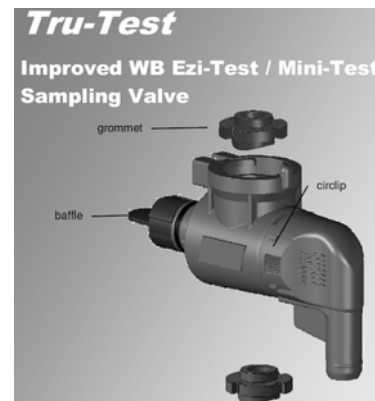

- ▶ New Stronger Valves in 2010
- ▶ Must replace whole valve
- ▶ Dark Charcoal in color
- ▶ Should reduce broken wash baffle issue

Tru-Test Auto-Sampler



- ▶ Mixing and sampling with push of button
- ▶ Labor-efficient
- ▶ Standard Bore (old) or Wide Bore (new) models
- ▶ High cost of ownership
 - Multiple service kits
 - Cap, sampler, valve and body damage

Waikato MK V



- ▶ Same mode of operation as Ezi-Test
- ▶ Annual Service Kit
- ▶ Don't forget to replace inlet hoses
- ▶ Durable
- ▶ Larger vacuum drop
 - Larger dome
 - More prevalent in large parlors

Tru-Test Farmer and Econo-Valve

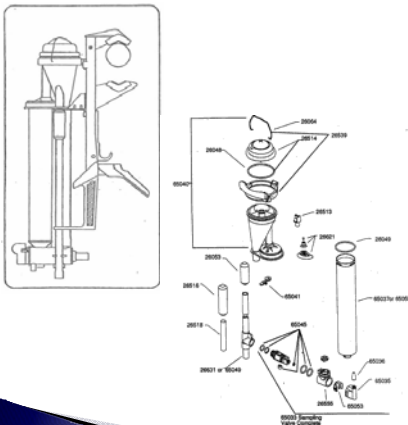

- ▶ Only Standard Bore models
- ▶ Over 20 years old
- ▶ No parts available
- ▶ Poor image of DHI
- ▶ Still approved but should be removed from service!

Unapproved DHI Meters





Meter Repair Tags

- ▶ Space for Tester Name, Date & Problem
- ▶ Quick ID of the problem
- ▶ Reduces down time
- ▶ Trace back

Calibration Requirements

Meter Calibration Requirements



- ▶ All meters must be calibrated at least once every 12 months
- ▶ Calibrated to within 2% accuracy
 - (35.7 to 37.1 pounds)
- ▶ Data is reported to QCS as part of annual field service audit

Meter Calibration Requirements



- ▶ Can calibrate more frequently
 - **Holstein Mexico – between every herd!!!**
 - **VDB (ID) – monthly**
 - **Tulare DHIA – quarterly**
 - **Arizona DHIA - quarterly**
 - NorthStar – 2x/year on some meters
 - Texas DHIA – 2x/year
 - DHA (CO) – 2x/year

Meter Calibration Requirements



- ▶ Meters must have a calibration sticker or tag with meter center name and year
- ▶ You have a choice in how they label or tag meters
- ▶ Dairymen have the right to refuse test if meter does not have a current calibration



Scale Calibration Requirements



- ▶ All Scales must be calibrated at least once every 12 months
- ▶ Calibrated to 2% accuracy level
- ▶ Calibrated @ 10, 20, 30, 40 & 50 lb levels
- ▶ Goats @ 1, 2, 5, 10 & 20 lb levels



Meter Storage and Transport

Meter Storage



Plastic totes provide convenient storage of up to 10 meters



Meter Storage & Transportation



Totes are easily carried into milk barn for setup

Totes cost approximately \$8

One replacement meter costs approximately \$350

CARE AND MAINTENANCE OF PORTABLE METERS – SIEVERT 2010



Meter Storage & Transportation



Truck bed cover keeps everything secure

Trailer transport for large herds

Truck cover=\$900
30 stolen meters=\$10,500



CARE AND MAINTENANCE OF PORTABLE METERS – SIEVERT 2010

Meter Storage & Transportation



PVC pipe racks
Holds 8 meters with Super Clamps
Easy transport and upright storage



CARE AND MAINTENANCE OF PORTABLE METERS – SIEVERT 2010

Meter Storage & Transportation



PVC pipe racks
Holds 10 meters with Dovetail Brackets
Easy transport and minimal damage (if any)



CARE AND MAINTENANCE OF PORTABLE METERS – SIEVERT 2010

Meter Mask



Protects against meter body damage from test cups and premature meter draining

Meter Mask= \$20.00

Meter Body=\$150.00



CARE AND MAINTENANCE OF PORTABLE METERS – SIEVERT 2010

Heavy Duty Meter Cleaning



CARE AND MAINTENANCE OF PORTABLE METERS – SIEVERT 2010

Cleaning and Sanitizing of Portable Meters

How clean are your meters?



CARE AND MAINTENANCE OF PORTABLE METERS – SIEVERT 2010

Initial Testing

- ▶ The first tests were done in the field by three technicians.
- ▶ Meters were “swabbed” prior to sanitizing, after sanitizing, and after usage and being washed.
- ▶ All meters appeared to be clean.

We wanted to see what would grow if we swabbed and cultured various parts of TruTest Meters that appeared to be clean



CARE AND MAINTENANCE OF PORTABLE METERS – SIEVERT 2010

Dairy One Cooperative Trial

- ▶ An additional trial was done in Ithaca to gauge the effectiveness of sanitizing in relation to time
- ▶ We did “time trials” to gauge the optimum amount of contact time for sanitizing



CARE AND MAINTENANCE OF PORTABLE METERS – SIEVERT 2010

Meter Swabs

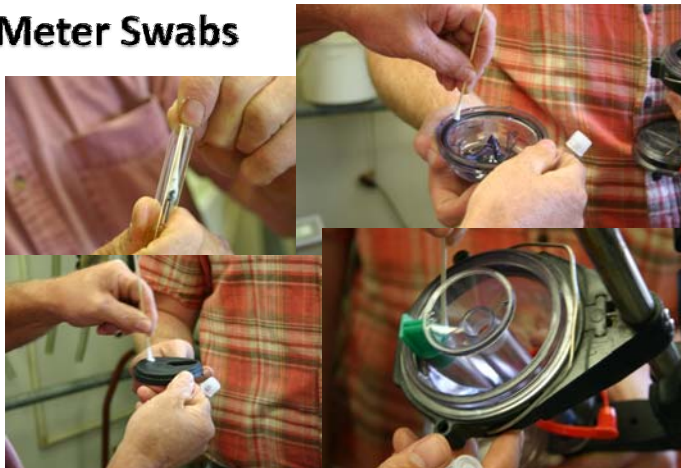

CARE AND MAINTENANCE OF PORTABLE METERS – SIEVERT 2010

Valve Swabs as well...



CARE AND MAINTENANCE OF PORTABLE METERS – SIEVERT 2010

Raw Data Recording

Pull Out Meter	Cover O Ring	VSO (oz)	Body
30 seconds	10	2	11
60 seconds	10	11	12
90 seconds	11	14	15
120 seconds	16	7	17
0 seconds	1	5	6

Valve Meter (EZI Test)	Inner Valve	Inner O Ring	Air Admittance
30 seconds	28	21	15
60 seconds	25	21	22
90 seconds	26	27	25
120 seconds	29	29	28
0 seconds	2	3	1

"Crabby O Ring"	New O Ring
Valve	71
Body	72
Cap	73
Valve	74
Body	75
Cap	76

Initial Findings

- ▶ We were able to culture and grow many organisms from meters that had been washed immediately after use and appeared to be clean. The field trial and the Ithaca Center trial yielded similar results.
- ▶ Meters that were cultured after being sanitized according to product specifications* were significantly less likely to be contaminated.
- ▶ * Two minutes contact time, 1 oz sanitizer/12 gallons lukewarm water

Conclusion:

- ▶ Sanitizing for two minutes just prior to the start of milking is necessary to insure our meters are clean, unless the meters will be connected and run through the dairy's regular sanitizing cycle.

Additional Findings

- ▶ The VSO must be removed after each use.
- ▶ The nozzle and cap o-ring must be removed regularly.
- ▶ The o-rings on valve meters need to be cleaned regularly.
- ▶ The rubber parts of the meters should be replaced on a planned schedule, suggest at meter test anniversary.

Findings on Residual Milk from Flask

- ▶ Several trials were conducted on the extra flask milk.
- ▶ In every case the culture results were TNTC- too numerous to count. Extra flask milk **must not** be added to the tank by Dairy One technicians*, and dairies should be discouraged from doing it as well.

* Dairy One Milk Handling Policy



CARE AND MAINTENANCE OF PORTABLE METERS – SIEVERT 2010

The long Handled Hose brush can be used to remove the nozzle



CARE AND MAINTENANCE OF PORTABLE METERS – SIEVERT 2010

The “bent” brush will fit into the meter body for cleaning.



CARE AND MAINTENANCE OF PORTABLE METERS – SIEVERT 2010

Don't forget the hoses...



CARE AND MAINTENANCE OF PORTABLE METERS – SIEVERT 2010

Cleaning Meters in Place (CIP)

- ▶ Add 1 gallon water and proper detergent for each meter in the line
- ▶ Physical cleaning of outside
- ▶ Clean the super clamp to ensure proper function
 - Air hose to remove debris
 - Immersion in hot water and detergent
 - Lubricant on metal only – not on polysulfone!



CARE AND MAINTENANCE OF PORTABLE METERS – SIEVERT 2010

Care of meters

- **Avoid contact with:**
 - ✓ Direct Sunlight
 - ✓ Petrochemicals & Hydrocarbons such as:
 - Fly spray
 - Brake or hydraulic fluid
 - WD40
 - Lubricants
 - super glue
 - Alcohols
 - Fuels



CARE AND MAINTENANCE OF PORTABLE METERS – SIEVERT 2010

Proper Sampling and Reading

43

Sample Mixing Research

- ▶ Minnesota DHIA Trial
- ▶ Used Tru-Test Pull-Out meters with 68# & 102# meters
- ▶ Removed flasks during milking, mixing thirds before sampling
- ▶ Simply poured milk without mixing



CARE AND MAINTENANCE OF PORTABLE METERS – SIEVERT 2010

58# milk in 102# Meter

poured without mixing

	<u>Fat %</u>	<u>MUN</u>	<u>Prot %</u>
Top	7.1	14	2.6
Middle	2.9	18	2.7
Bottom	2.6	19	2.7



CARE AND MAINTENANCE OF PORTABLE METERS – SIEVERT 2010

51# of milk in 68# meter

	<u>Fat%</u>	<u>MUN</u>	<u>Prot %</u>
Last 8#	9.9	16	3.0
Middle 22#	4.0	18	3.5
First 21#	2.4	22	3.6



CARE AND MAINTENANCE OF PORTABLE METERS – SIEVERT 2010

65# of milk in 102# meter

	<u>Fat %</u>	<u>MUN</u>	<u>SCC</u>
Last 11#	6.03	14	722,000
Middle 19#	3.63	15	252,000
First 15#	1.65	21	188,000



CARE AND MAINTENANCE OF PORTABLE METERS – SIEVERT 2010

37# of milk in 68# meter

<u>Poured 2x</u>	<u>Fat %</u>	<u>MUN</u>	<u>SCC</u>	<u>Prot %</u>
Top	3.76	15.3	62,000	3.19
Middle	3.75	15.5	63,000	3.19
Bottom	3.76	15.1	57,000	3.18



CARE AND MAINTENANCE OF PORTABLE METERS – SIEVERT 2010

Findings on Sample Mixing

- ▶ Employ proper mixing of flask milk for every cow
 - Pull-Out Flasks – minimum of 2x (4x recommended)
 - Ezi-Test Meters – 10 seconds if flask is more than ½ full
 - Ezi-Test Meters – 5 second if flask is less than ½ full
 - Waikato Meters – 10 seconds
 - May need to be twice as long in cold weather/cold parlors
- ▶ Fill sample vials immediately and shake to disperse preservative
- ▶ DHIA labs have protocols in place for sample handling and mixing before analysis



CARE AND MAINTENANCE OF PORTABLE METERS – SIEVERT 2010

Reading the Flask Volume



- ▶ Read the **BOTTOM** of the meniscus
- ▶ **Foam does NOT count**
- ▶ Read between the lines
 - 1 lb marks – read to ½ lb
 - ½ lb marks – read to ¼ lb
- ▶ **Consistent reading from start to finish**
- ▶ **Replace worn flasks**



CARE AND MAINTENANCE OF PORTABLE METERS – SIEVERT 2010

50

Some Final Thoughts on Meters

- ▶ Start with clean, sanitized meters
- ▶ **Minimize hose length**
 - Reduce vacuum loss
 - May have to have different hoses for different dairies
- ▶ Clean the outside as well as the inside
 - CIP is NOT enough!
 - Protect meters – wax, etc.
- ▶ Service and repair meters often
 - Share what is going on!
 - Replace VSO & gaskets
- ▶ Read the meters properly without influence from dairy owner
- ▶ Use proper sampling techniques

EQUIPMENT PERFORMANCE

FIELD TECHNICIAN
PERFORMANCE

CARE AND MAINTENANCE OF PORTABLE METERS – SIEVERT 2010

51

Your Challenge is...

- ▶ You control your image...
 - *Professional appearance*
 - *Properly operating equipment*
 - *Proper technique*
 - *Exceed the minimum requirements*
 - *Communicate your needs with management*
- ▶ Resulting in...
 - *Accurate and consistent results*
 - *Fewer concerns and/or complaints from dairymen*
 - *Customer retention and satisfaction*



CARE AND MAINTENANCE OF PORTABLE METERS – SIEVERT 2010

52

Quality Certification Services Inc.

- Performance & Quality Standards
- Compliance Auditing of Providers
- Education, Training, & Development

A simple, yet vital mission....

Providing a reliable source of information to people interested in the U.S. dairy records industry.

